

CubeX™ Setup



Please refer to the CubeX™ User Guide for safety and comprehensive operating instructions. You can find the CubeX™ User Guide on Cubify.com.

SAVE ALL FOAM AND PACKING MATERIAL FOR FUTURE USE. SHIPPING WITHOUT ORIGINAL PACKING MATERIAL MAY CAUSE DAMAGE TO PRINTER.



1

Open the box

Open box and remove top plastic lid located between top two layers of foam. Set aside foam inserts for future repacking.

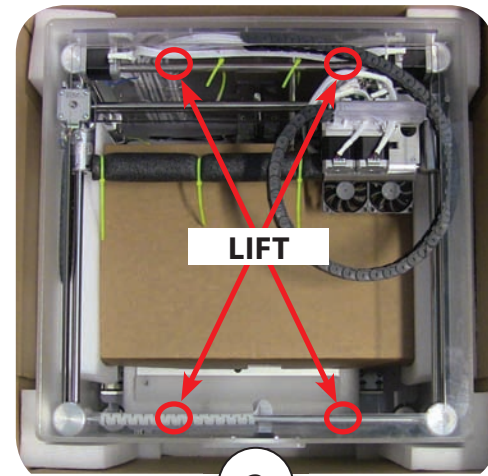

2

Lift CubeX™ out of box

Have two people lift CubeX™ out of box, using metal frame on front and rear of printer. **DO NOT** lift using plastic enclosure as it may damage the enclosure.

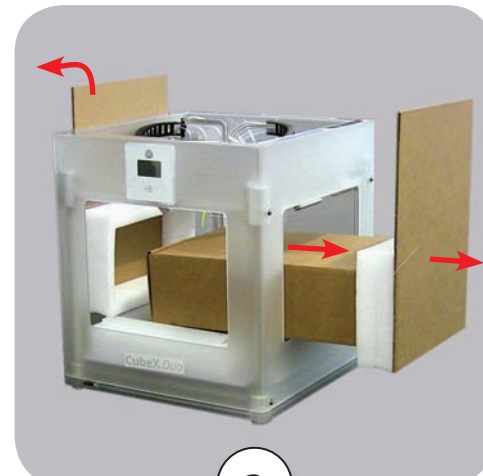

3

Remove accessories box

Foam corners will fall off when printer is lifted from carton. Remove side padding. From either side, slide accessory box out of printer.

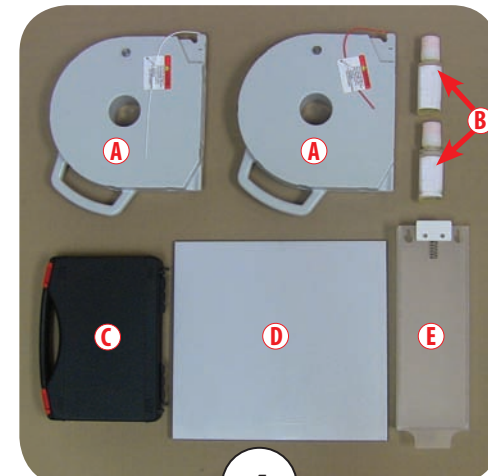

4

Open accessories box

Accessories box contains: 1–3 print cartridges depending on model (A), 2 Magic CubeX glue bottles (B), tool kit (C), print pad (D), and jet wiper (E).

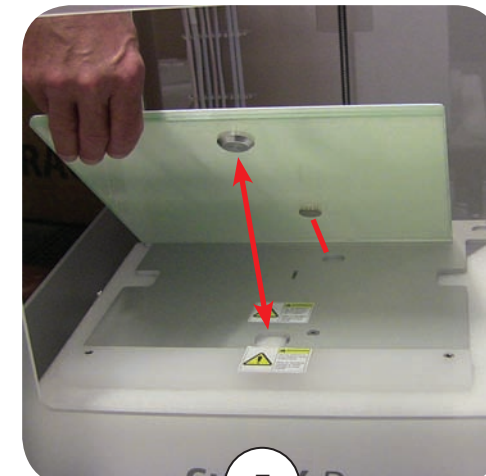

5

Install print pad

Place print pad, white side up, onto print platform matching magnets on bottom of pad to corresponding holes on top of platform.

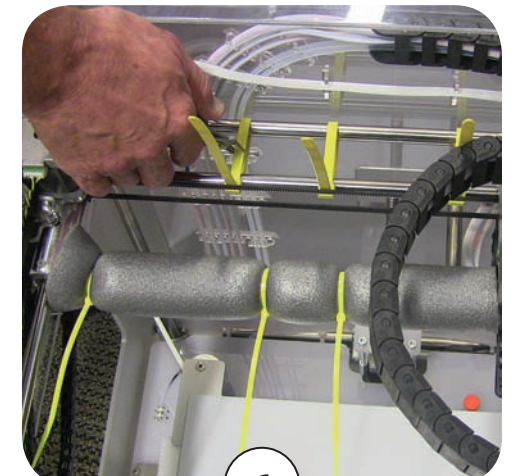

6

Cut away zip ties

Cut away all zip ties from print jet and foam tubing.

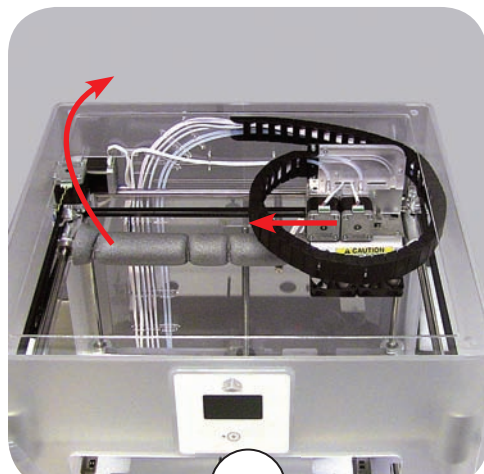

7

Remove foam tubing

Take off all foam tubing. Slide print head to the left.

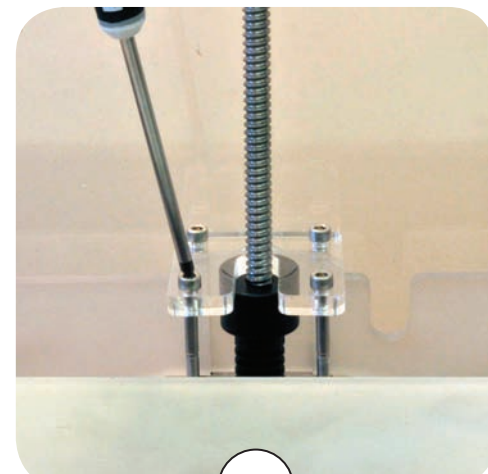

8

Remove guard screws

Remove clear plastic Z-Axis guard, by unbolting 4 screws holding it in place.

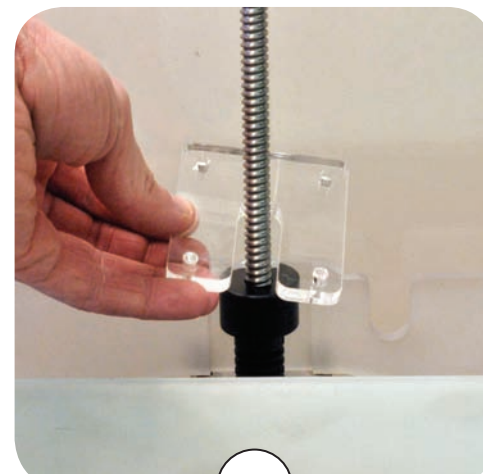

9

Remove guard

Lift out clear plastic guard after all screws are removed. Save guard and screws for repacking.



10

Plug in power cord

Tilt front of printer up to plug in power cord. Cord can be found packed in manila envelope. Plug is located beneath CubeX™.

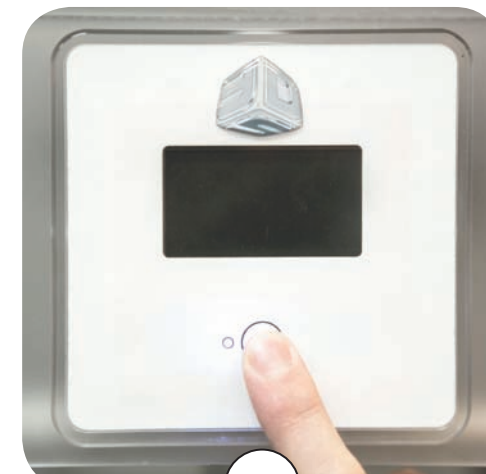

11

Power on

Press power button under LED screen to power on your CubeX™.



12

Activate

Activate through cubify.com using your activation ID shown on the display. Your Serial Number can be found on the back of your CubeX™.

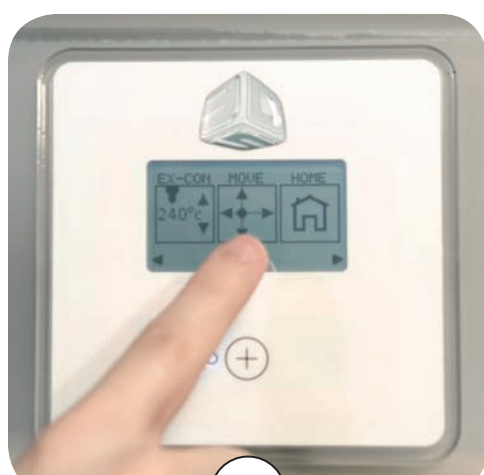

13

Move function

Using touch screen, navigate to the move function.

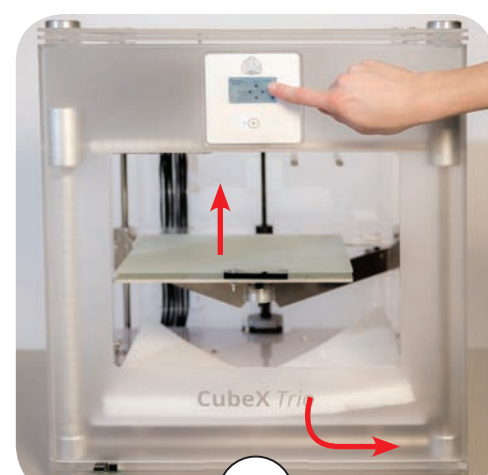

14

Move print pad up

Using up arrow, move print pad up far enough to remove foam. Remove foam pad beneath print pad.

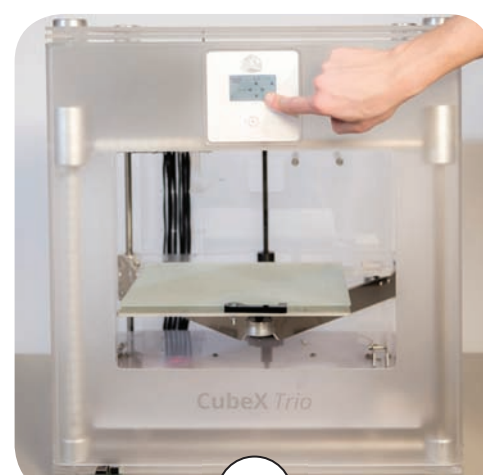

15

Lower print pad

Move print pad down as far as possible to install jet wiper.

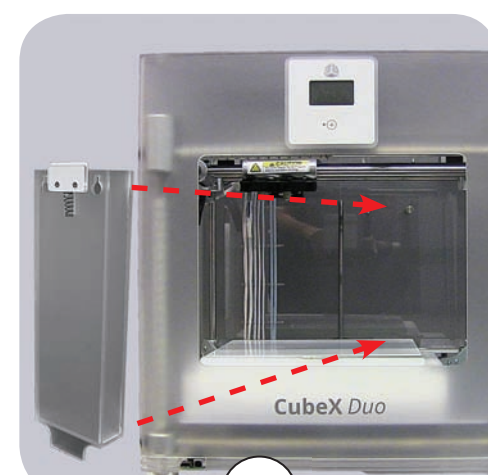

16

Install jet wiper

With spring tip facing front, insert bottom tab of jet wiper into slot located in front of orange adjustment screw at bottom of unit.

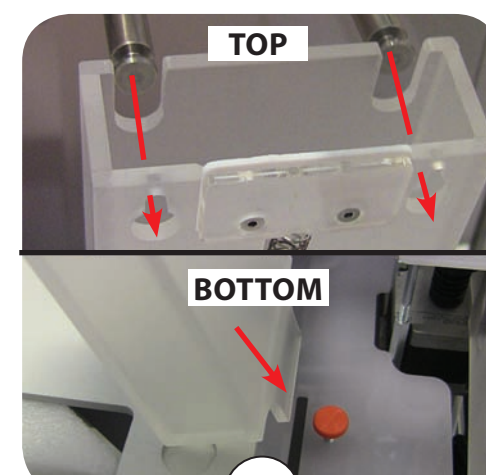

17

Install jet wiper

Align the top holes in jet wiper with posts under left side of printing bars. Slide jet wiper over posts until all the way through jet wiper box.

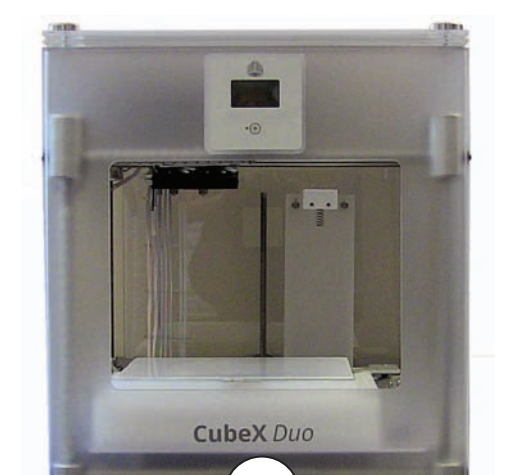

18

Ready

Follow directions from guide on Cubify.com to complete setup.



Support:
cubify@cubify.com



Connect:
facebook.com/cubify



Follow:
[@cubify](https://twitter.com/cubify)

CubeX™ Repack



Please refer to the CubeX™ User Guide for safety and comprehensive operating instructions. You can find the CubeX™ User Guide on Cubify.com.

USE ALL PACKING MATERIAL FROM ORIGINAL PACKAGING. SHIPPING WITHOUT ORIGINAL PACKING MATERIAL MAY CAUSE DAMAGE TO PRINTER.

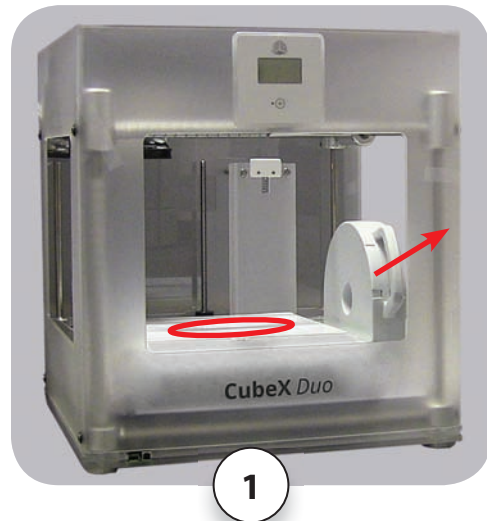

Remove print cartridges

Remove print cartridge(s) from printer and any remaining printing material from print pad.

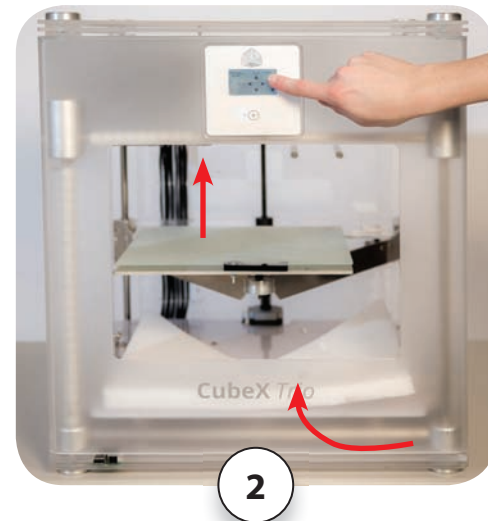

Move print pad up

Using touch screen navigate to the move function. Use up arrow to move print platform up far enough to place foam pad beneath print pad. Lower print platform back down on foam.



Power off

Press power button under LED screen to turn off printer. Unplug printer from wall or power strip. Tilt the front of the printer up and unplug power cord beneath CubeX™.

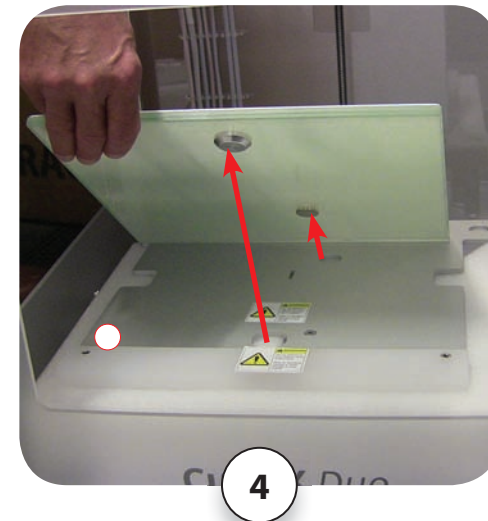

Remove print pad

Lift print pad up and off the print platform.

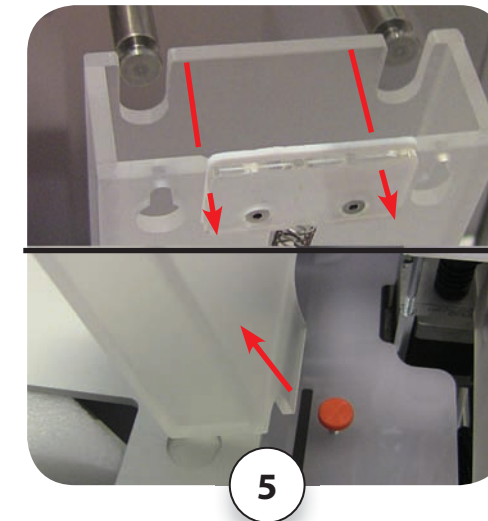

Remove jet wiper

Slide print head to left side of printer. Slide top holes of jet wiper up then forward off back posts on printer. Lift jet wiper up and out of slot on bottom of printer.

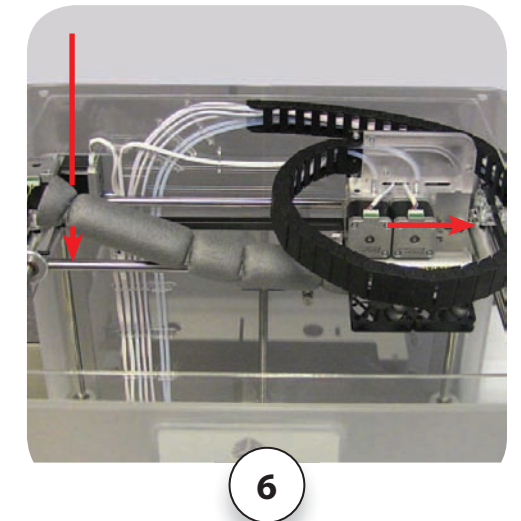

Replace foam tubing

Slide print head all the way to the right. Install foam tubing from original packaging on first print head bar.

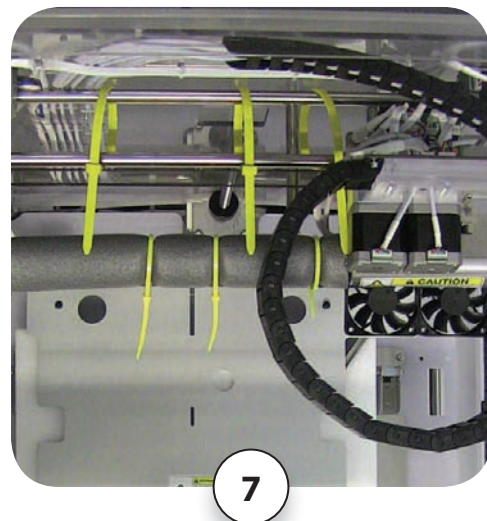

Secure print head

Place new zip ties on foam tubing and two rear bars to keep print head from moving. Make sure you DO NOT enclose print head belt within ties.



Replace guard

Replace original Z-Axis guard, by placing guard around base of Z-Axis transit clamp and using original 4 screws to hold it in place.

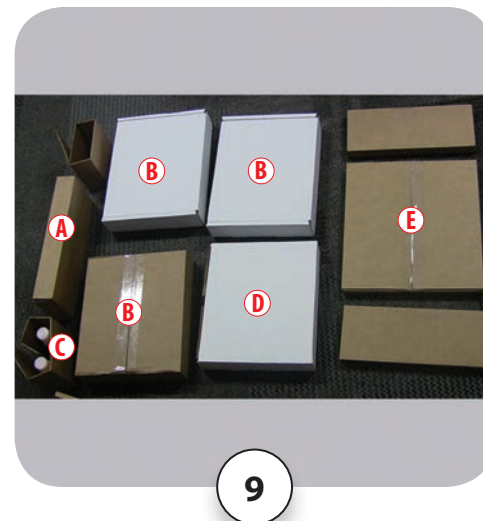

Repack Accessories

Place all accessories back into original boxes and tape closed. Jet wiper (A), 1–3 print cartridges (B), 2 Magic CubeX glue bottles (C), tool box (D), and print pad (E). Empty boxes are spacers.



Repack accessories box

Place Magic CubeX glue, jet wiper and open spacer upright against front of accessories box. Layer remaining boxes: 2 “B” boxes bottom, “B” and “D” boxes middle and “E” box between spacers on top.

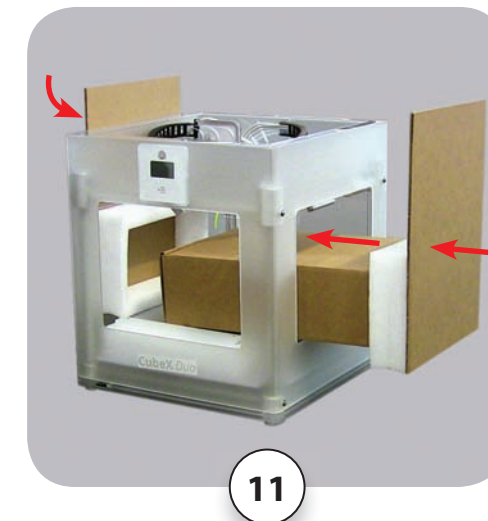

Slide box into printer

From either side, slide accessory box into printer and onto build platform. Insert foam ends of side padding onto each end of box. Sides will stick out a few inches.



Replace bottom padding

Place bottom layer of foam into bottom of packing box. Make sure that raised corners are facing up in order to protect printer.

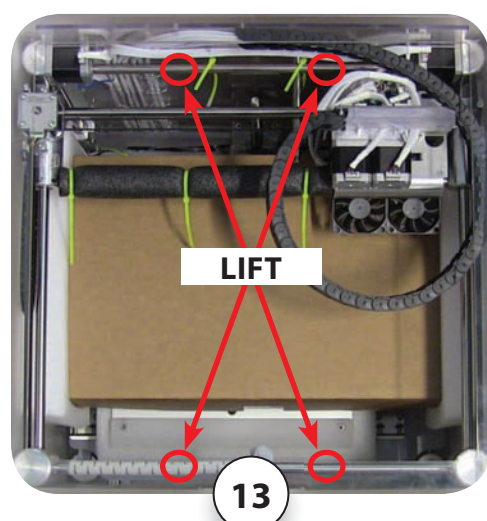

Lift CubeX™ into box

Have two people lift CubeX™ into box, using metal frame on front and rear of machine and insert into foam corners. DO NOT lift using plastic enclosure as it may damage the enclosure.

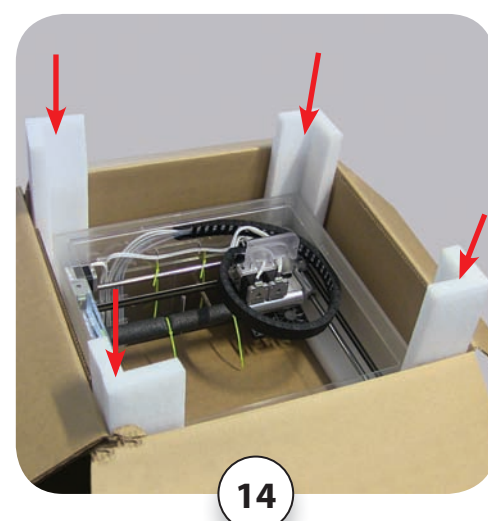

Insert corner pads

Slide all four foam corner pads into corners between printer and box.

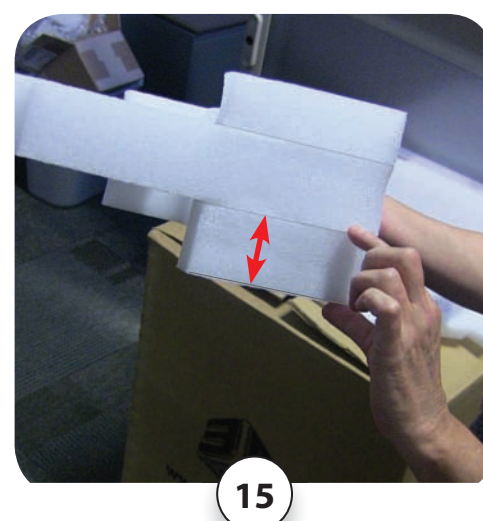

Cover CubeX™

Place top piece of foam pad over printer. Make sure that the thickest corners are facing down.

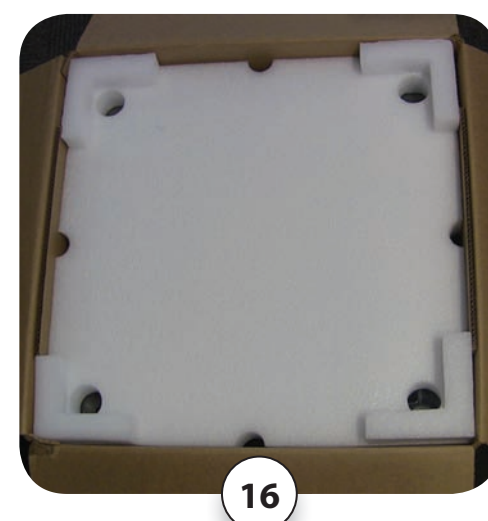

Cover CubeX™

Top piece of foam should lay flush with the top of the box.

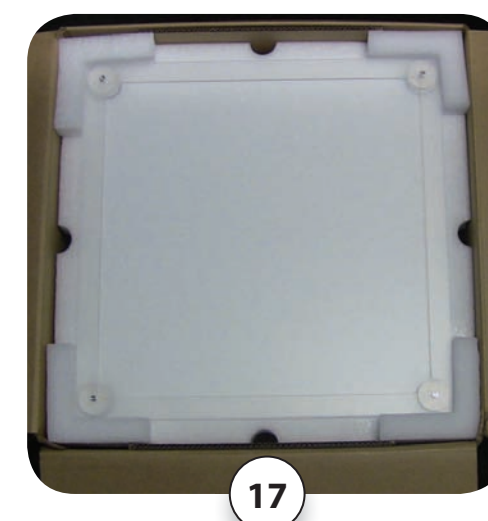

Repack top

Place plastic lid over foam. Align the round corner supports on lid with corner holes in foam.

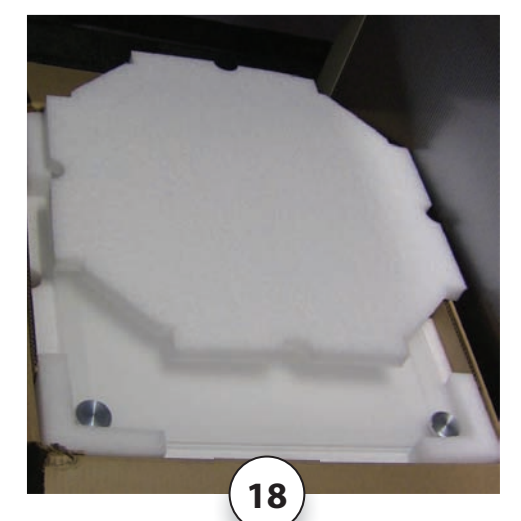

Close the box

Place final octagonal foam pad over printer top. Close box and seal.



Support:
cubify@cubify.com



Connect:
facebook.com/cubify



Follow:
[@cubify](https://twitter.com/cubify)

© 2013 3D Systems, Inc. All Rights Reserved. 3D Systems, the 3D Systems logo, Cube, and Cubify are registered trademarks of 3D Systems, Inc.

RoHS WEEE