



**3DXpert™**

# **3DPRINTING EXERCISE**

## **Create Barcode**

Tutorial\_V2- Updated: 3DXpert 16 Sp1

# Table of Contents

Part 1 – Create Barcode or 2D Barcode ..... 3

Create a Barcode or a 2D Barcode geometry and place them on objects

## Part 1 – Create Barcode or 2D Barcode

1. Unpack the file **barcode.ctf** and load the assembly.
2. From the 3D Printing menu select the option: Create Barcode Geometry.

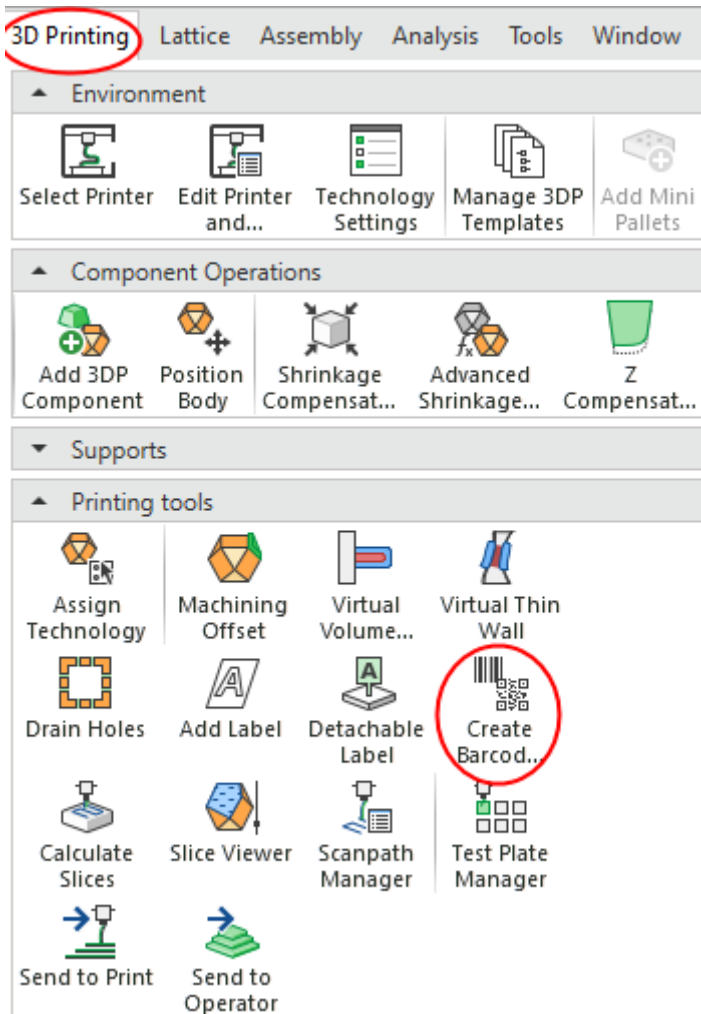

3. Select the Barcode option & define the text as **Tutorial**. Set the barcode format as **Code128** and select **OK**.

When selecting a specific barcode or 2D barcode format, a preview of the resulting shape is displayed in the dialog, as shown below.

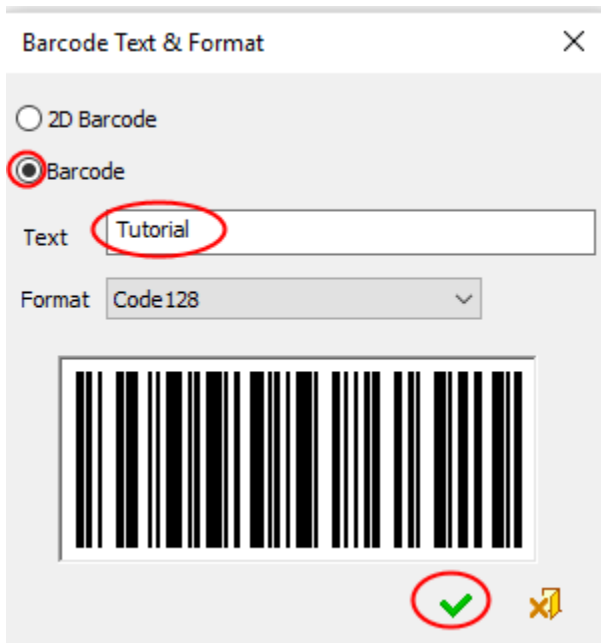

4. Accept the default parameters. Place the barcode as indicated by the arrow in the picture below:

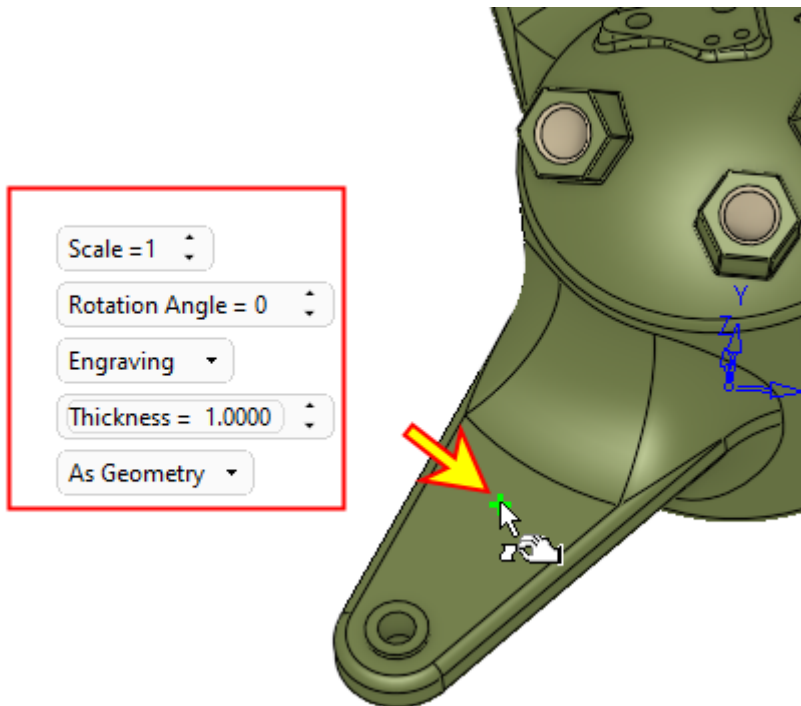

5. The barcode is too big.

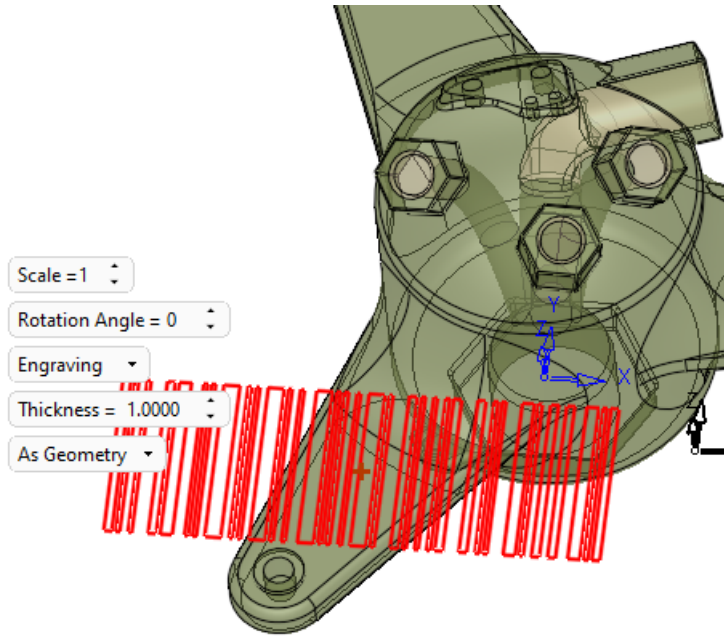

6. Set the Scale and the rotation angle as shown in the picture below:

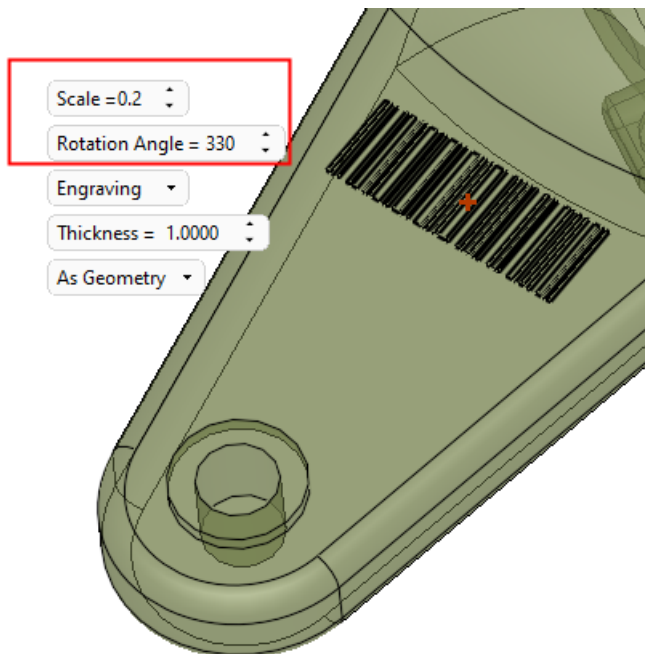

7. Apply a thickness of 1. Press the Preview button.

The thickness value defines the depth or height of the text, according to the option selected. This applies to all options except Sunken Protrusion. For Sunken Protrusion, if the Thickness is 1 mm the text is created 1 mm inside the object and 1 mm outside the object (for a total thickness of twice the selected value).

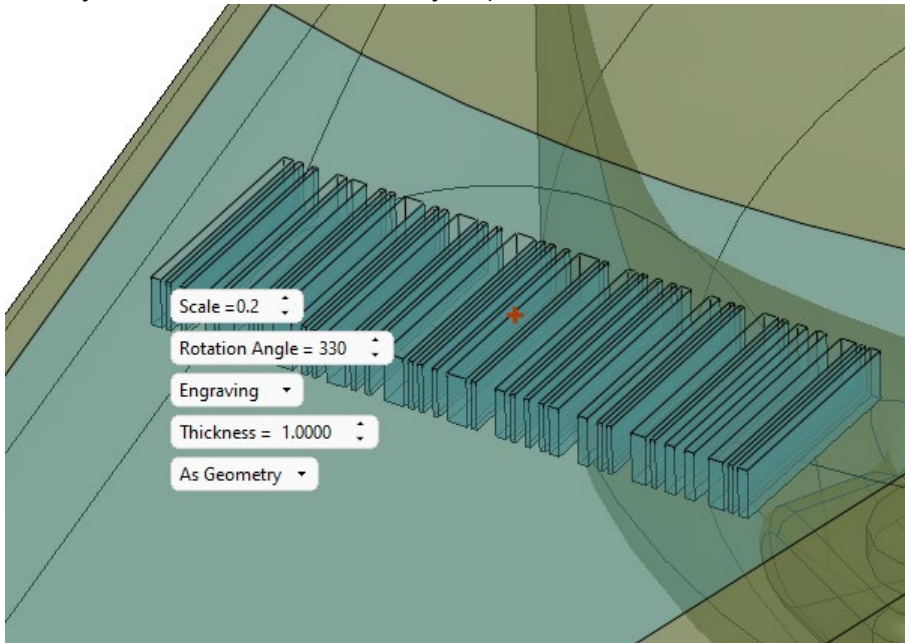

8. Select the option Protrusion. See how the text is added, protruding from the object.

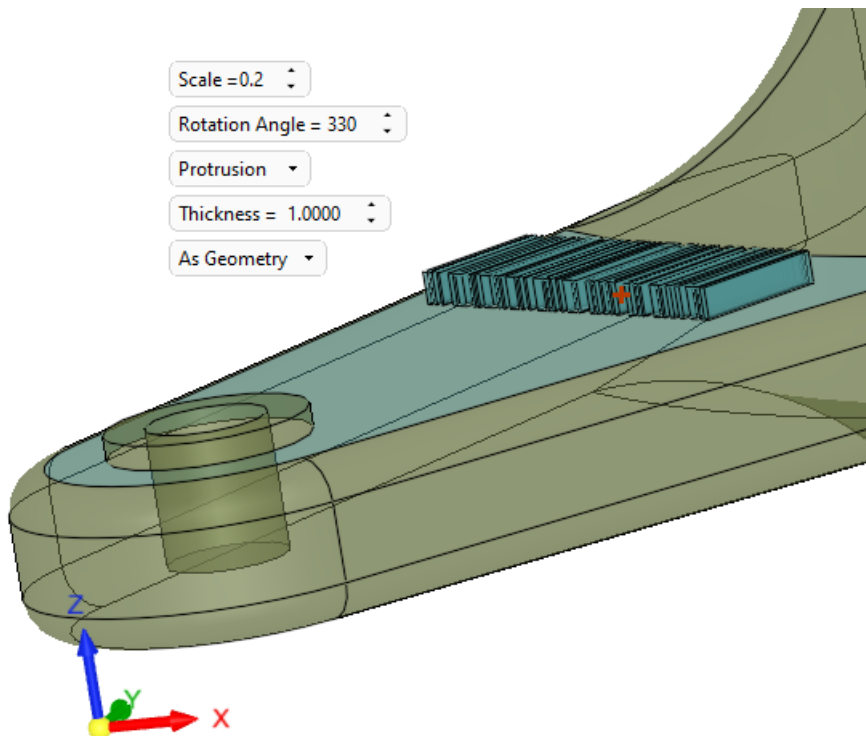

9. Set the option to Sunken Protrusion.

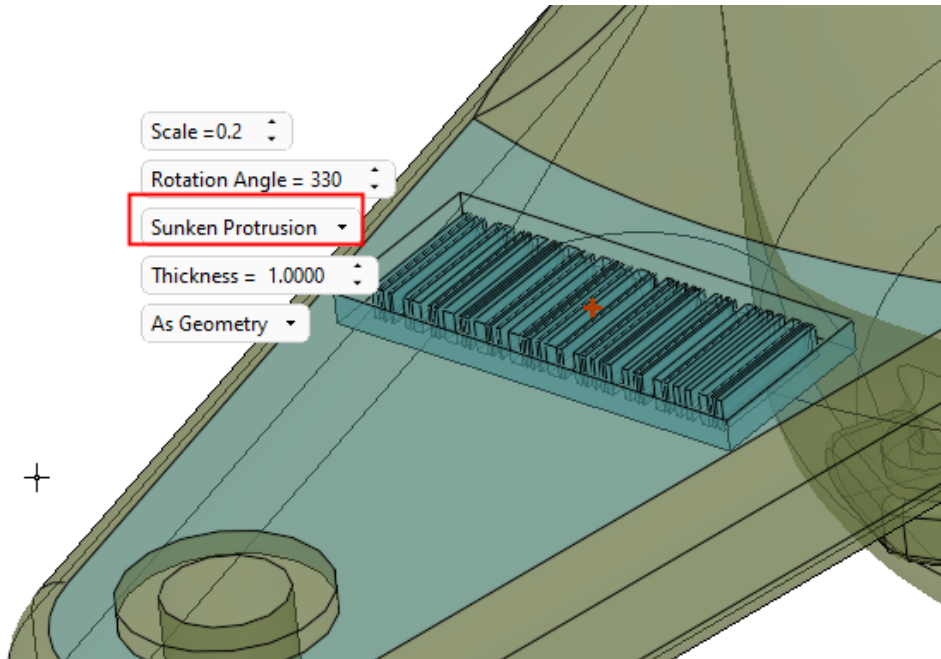

10. Set the **Engraving** mode with **thickness of 0.2**. Examine the preview result.

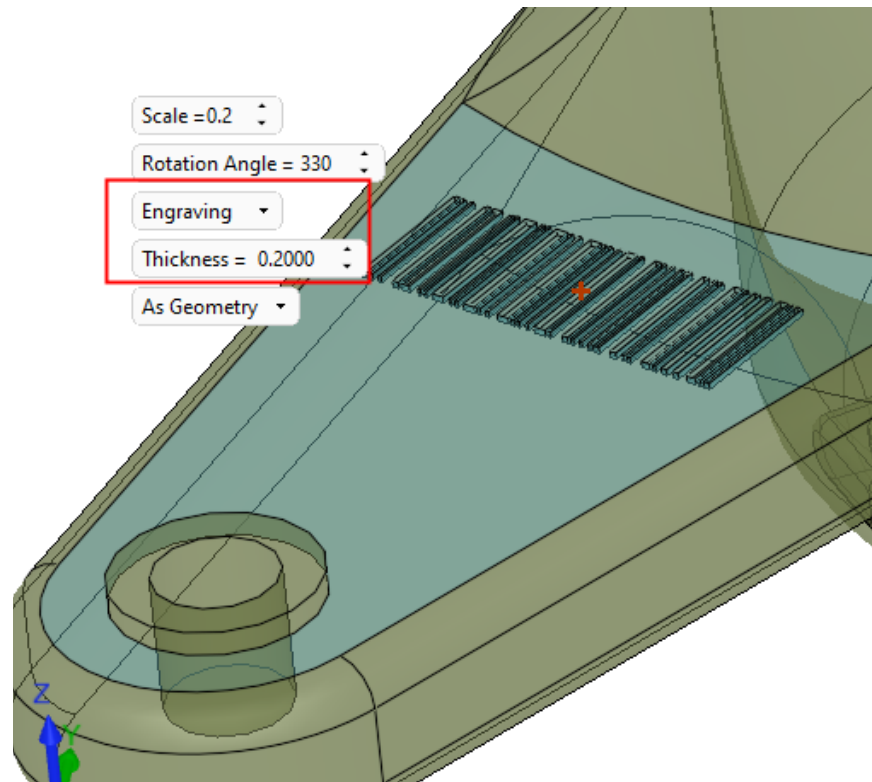

11. Toggle the As Geometry option to As Label. This toggle option switches between creating a barcode as 3D geometry and as a wireframe label.

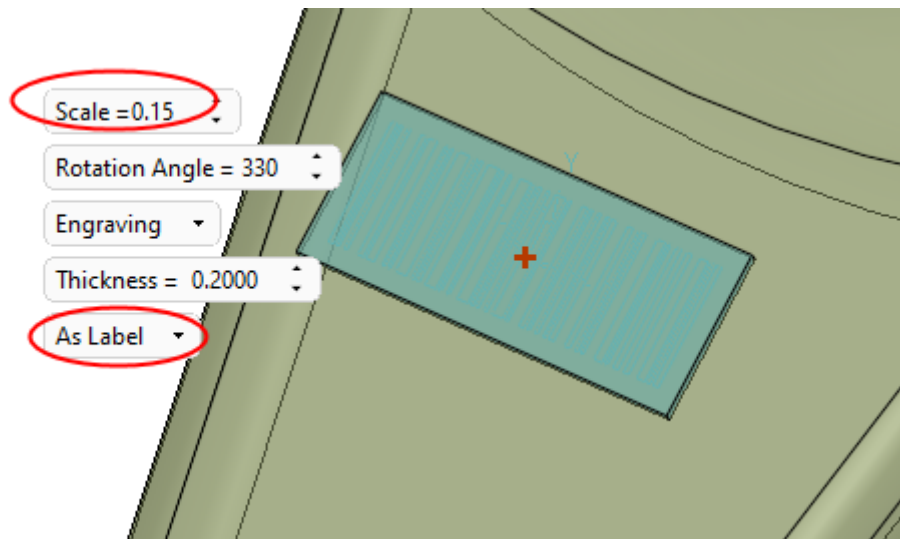

12. Re position the barcode, if needed, so it will fit the part better.

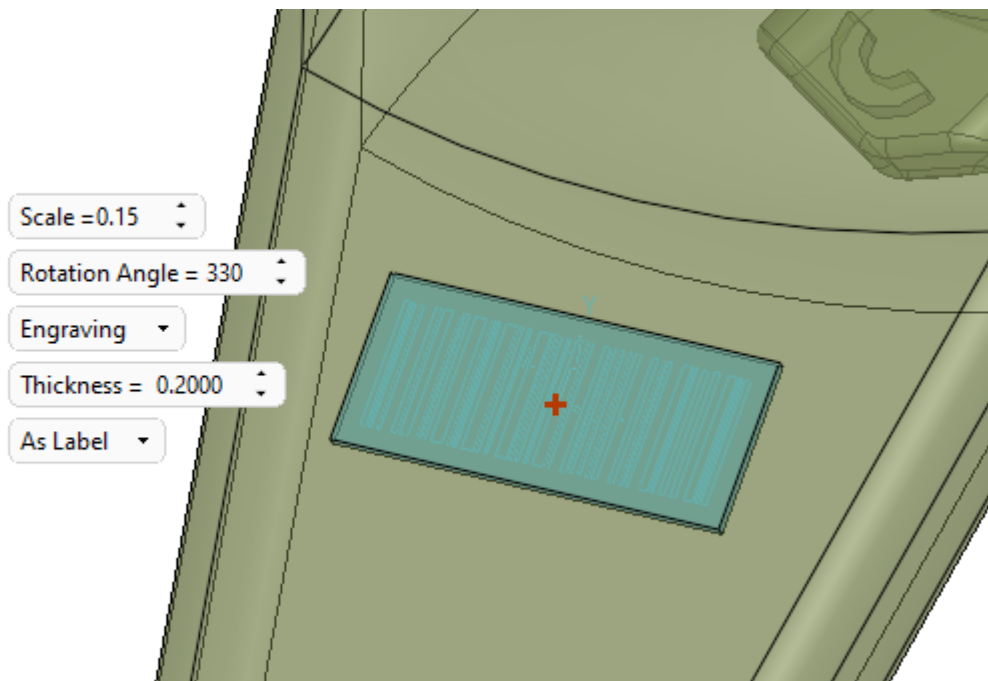



13. Finally, switch back to As Geometry and select **OK**.

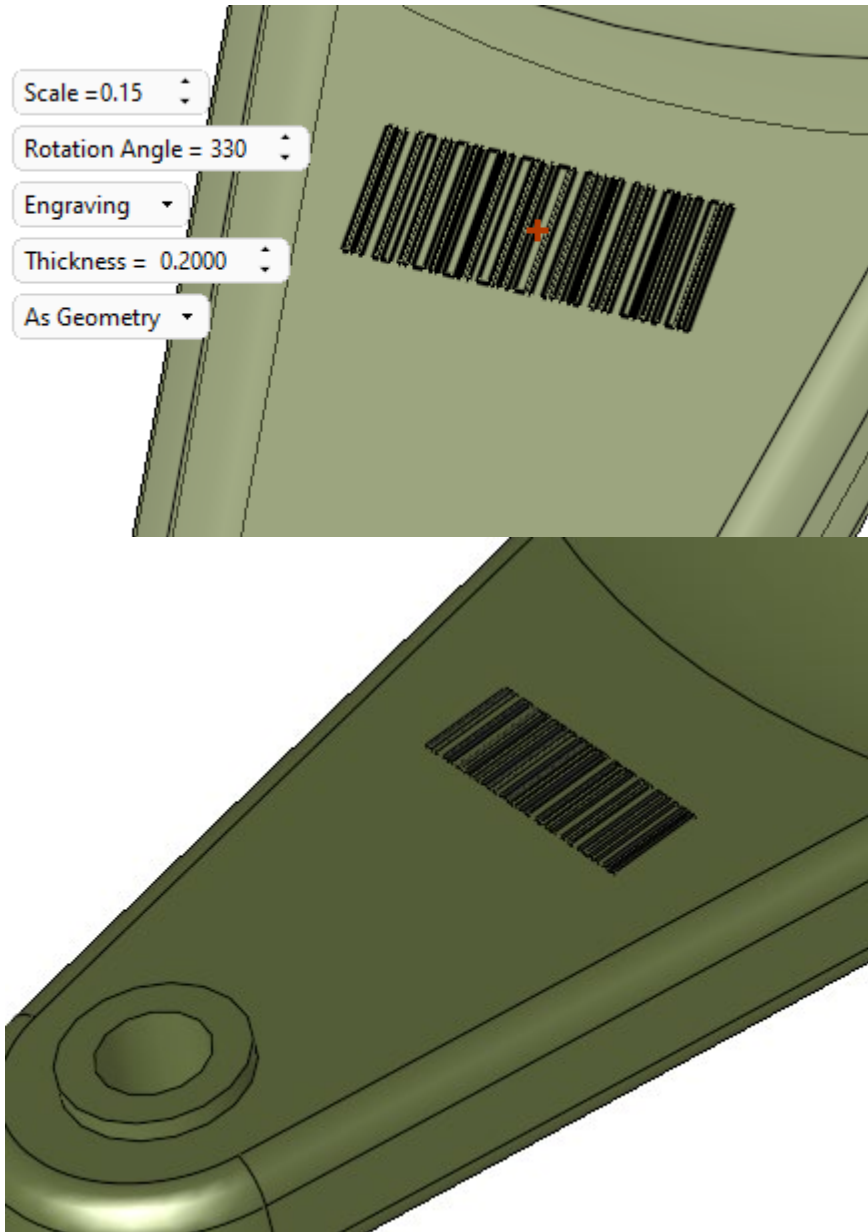

14. A barcode Text & Format feature appears in the tree. Edit this feature.

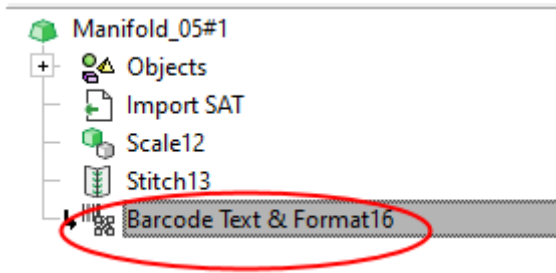

15. Enter the first required step in the feature guide.

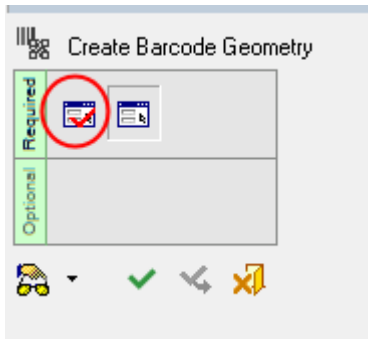

16. Select the 2D Barcode button. In the text field write: “Tutorial” and select OK.

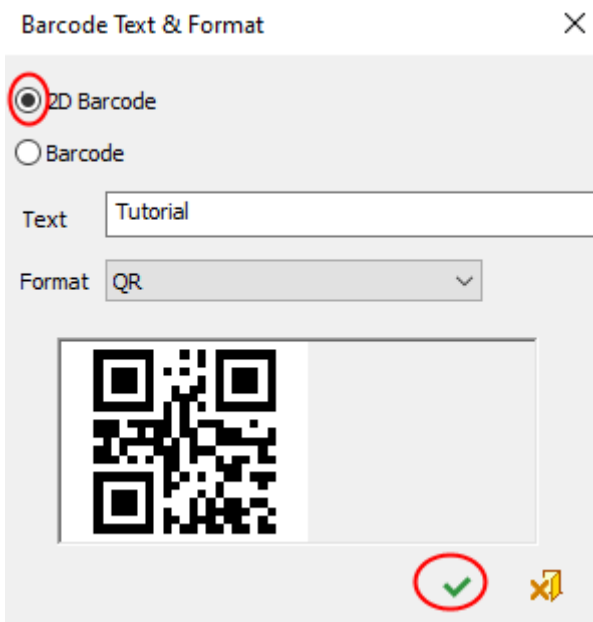

17. Set the parameters as shown below and select **OK**.

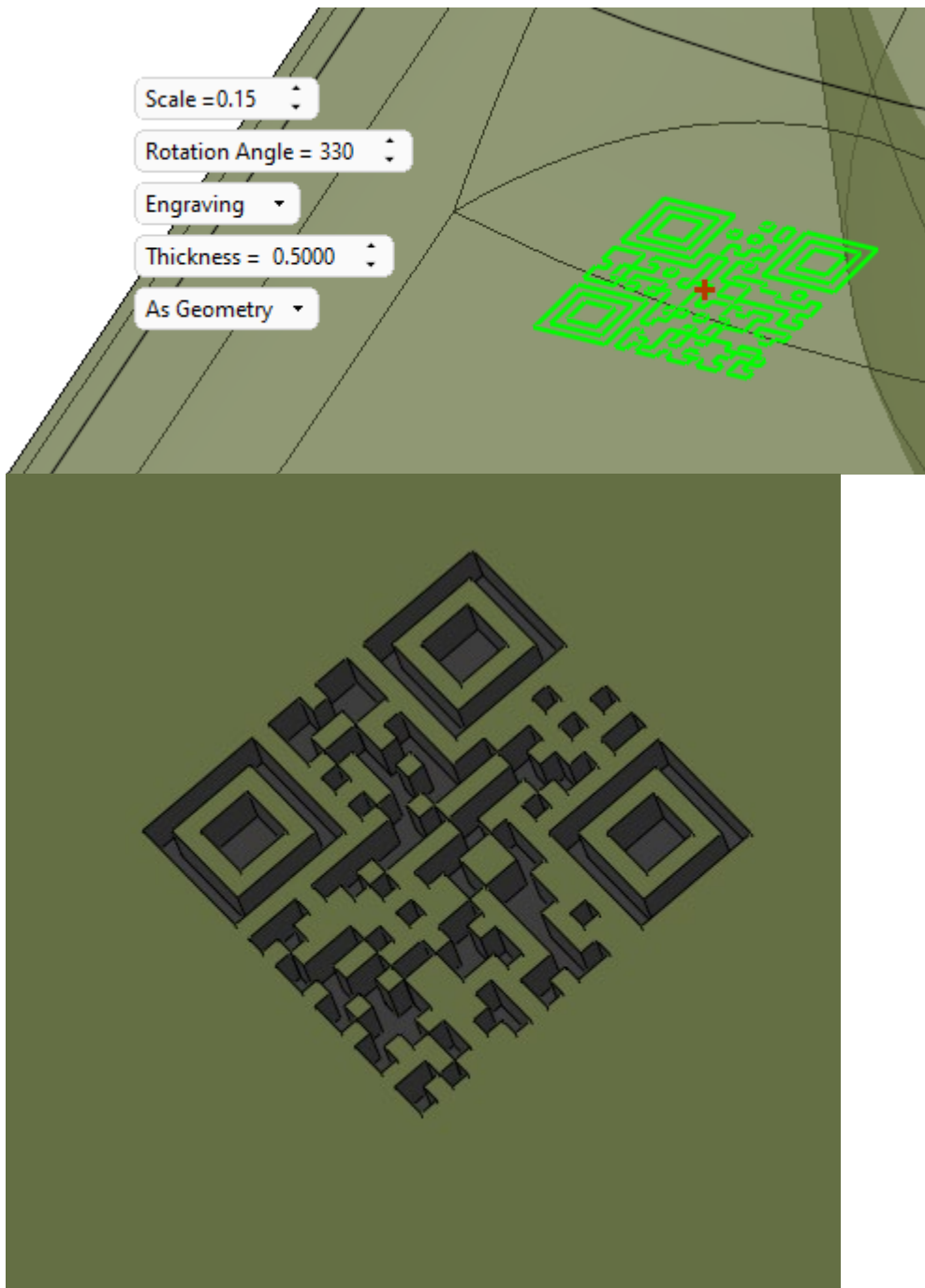

End of Exercise