

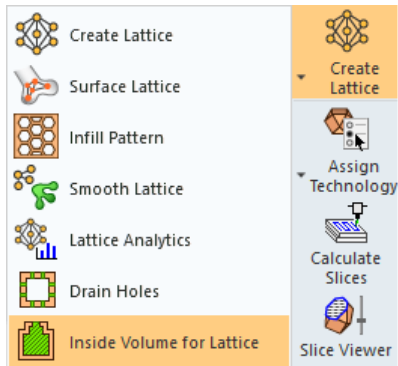

INSIDE VOLUME FOR LATTICE

Tutorial_V1 - Updated: 14,0305,1635,1264(SP3P5)

1. Load the file **Cage-Start.elt**.
2. From the Guide click the Create Lattice icon and from the list select Inside Volume For Lattice



3. Pick the object shown here:

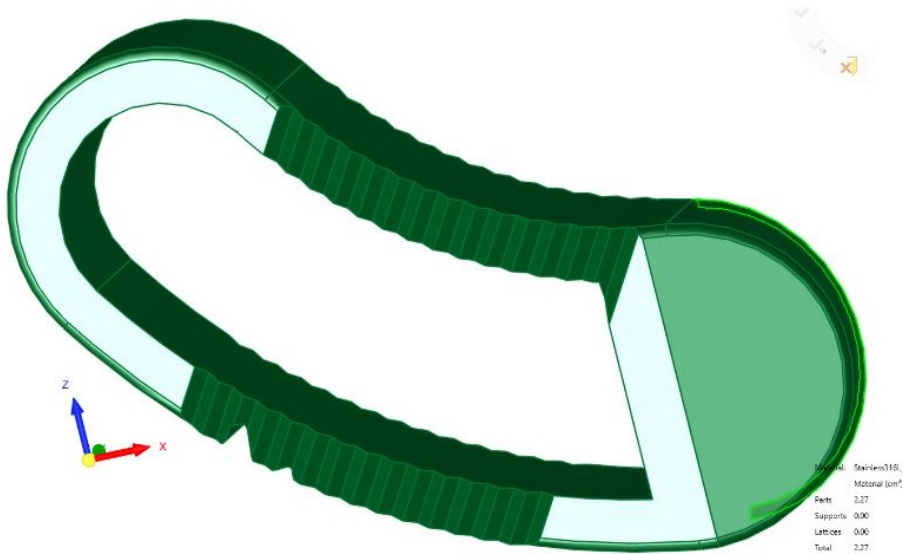

- The next step is to pick the Stop Faces. You can pick one, as the selection will propagate and the rest of the faces will be selected), do not press Exit yet.

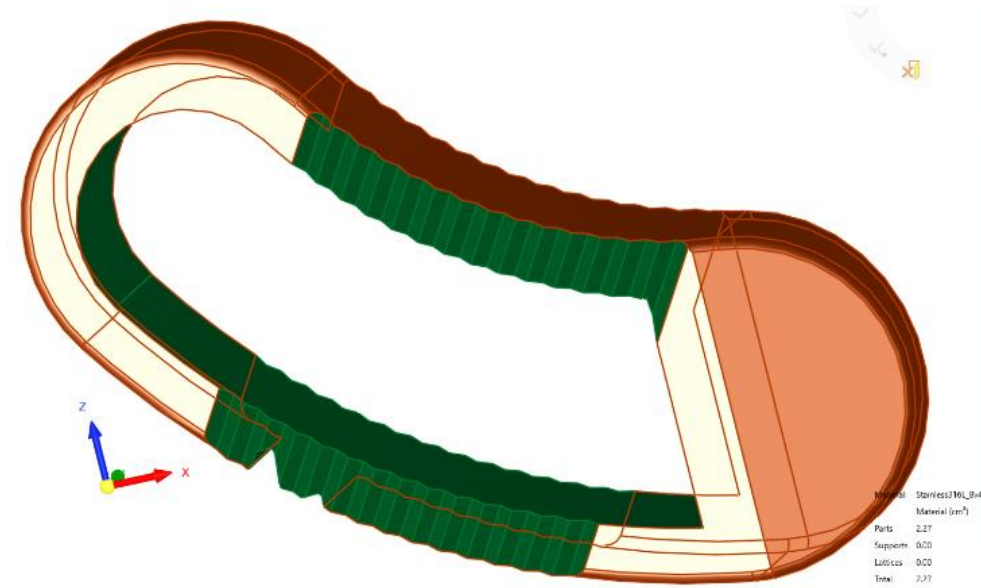

- Use ZPR to look at the object from XZ the direction

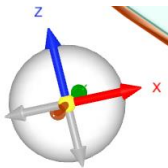

Set the Selection Filter to select only visible faces:

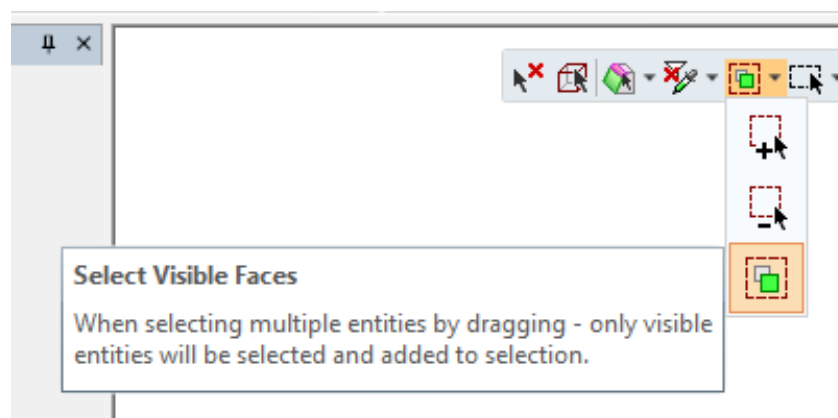

6. Select by box these faces, as shown here.
If any face is not picked, pick it manually.

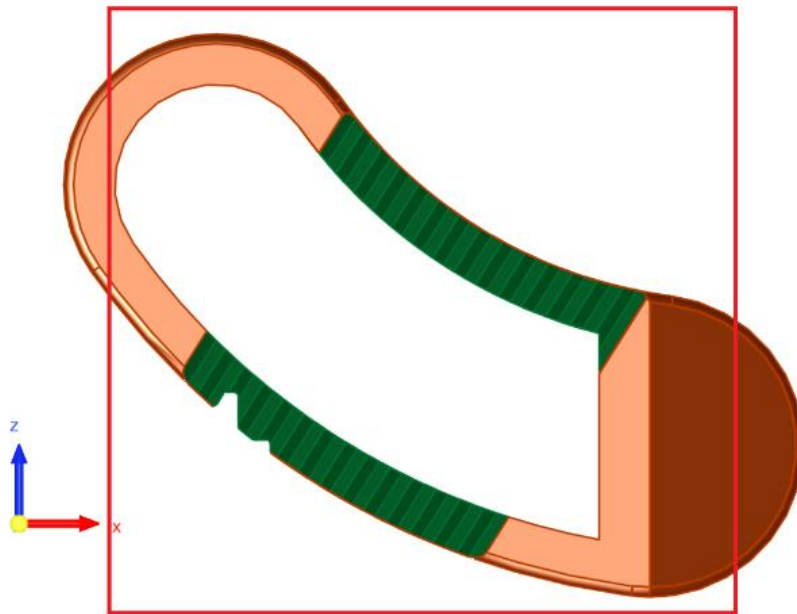

7. Rotate the part by 180 degrees and pick again from the other side:

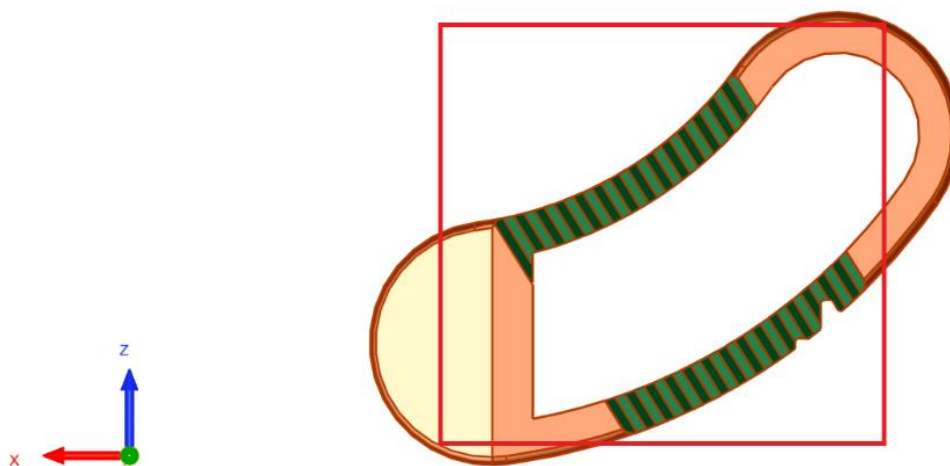

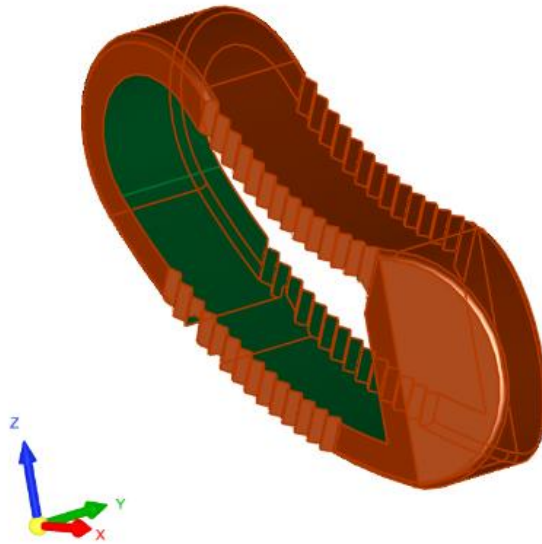

8. Press the middle mouse button of the mouse to exit the selection.

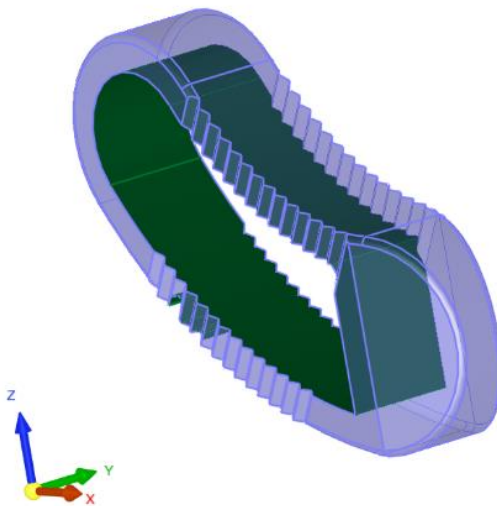

9. Next, pick Internal faces. Pick any of faces, and the selection will propagate to the rest.

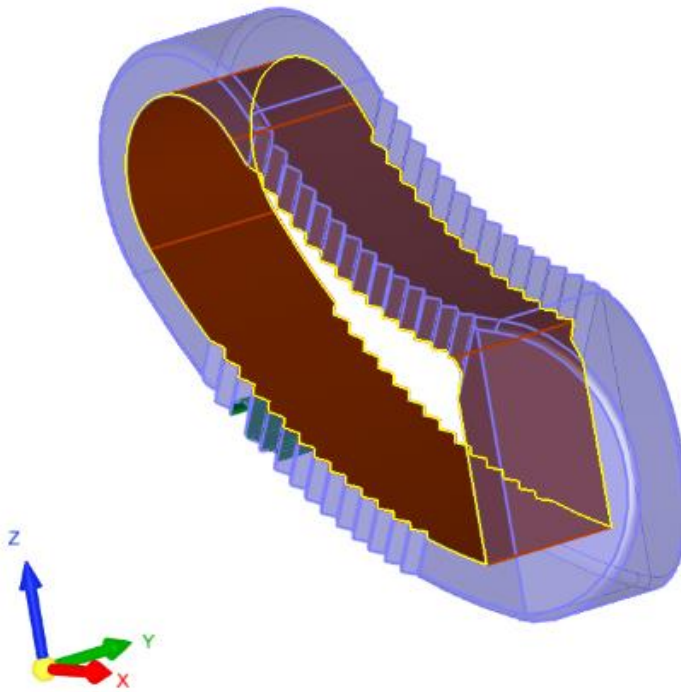

10. Press OK



Result – the inner volume of the part is now filled with a solid object.

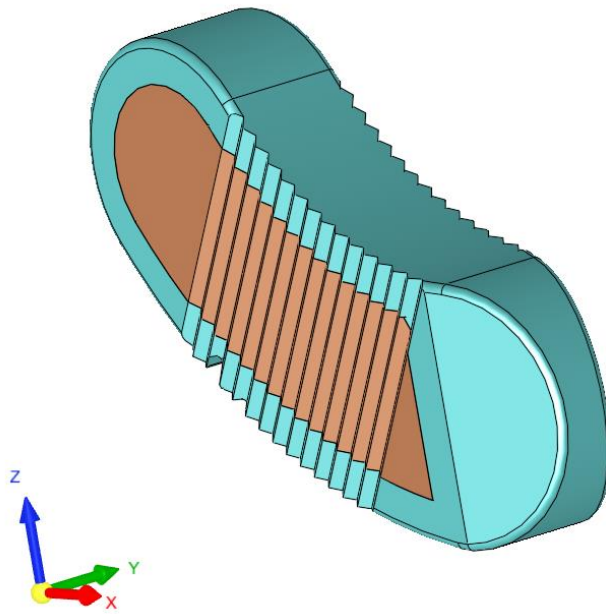

The result

11. Now you can enter Volume Lattice and create a lattice on this internal volume

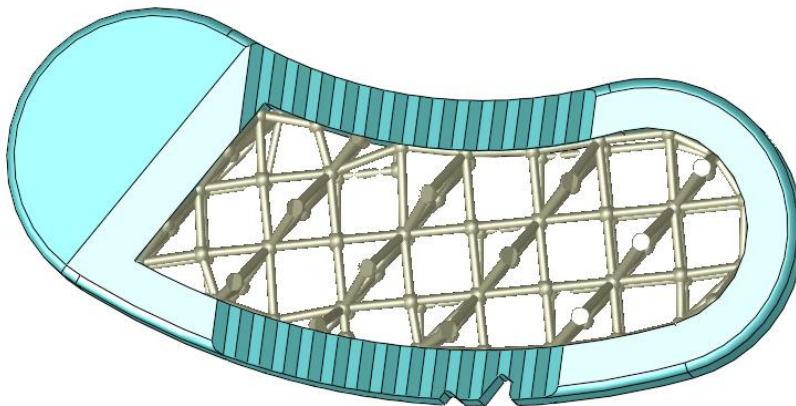

End of Exercise